



Review
2014

DEICKE RICHARDS





New USC facility

The Resources Building at the University of the Sunshine Coast addresses the future town centre at Sippy Downs and provides a logistics facility at the campus perimeter. The three-storey development is home to human resources, marketing and communications and information management services, an IT services workshop, a printery and records archive.





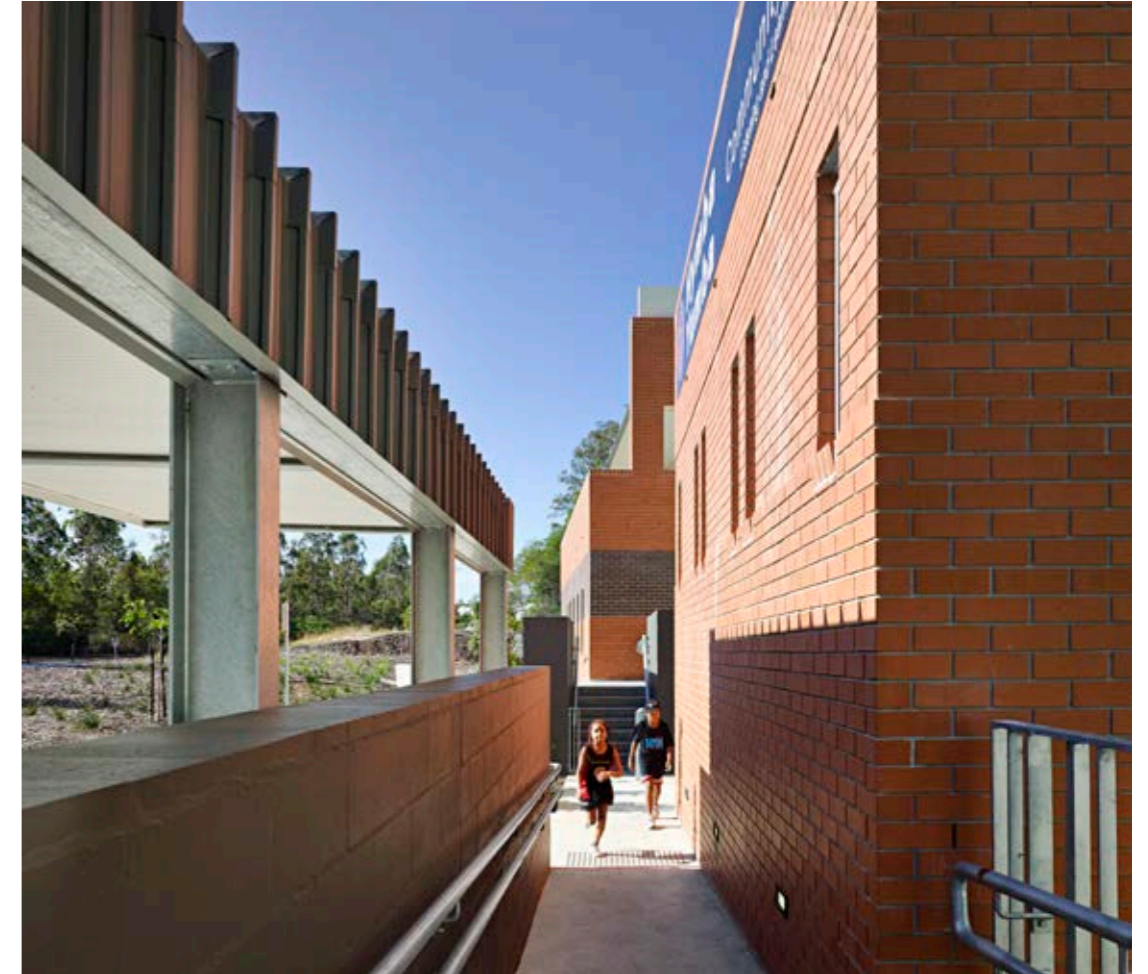

Independent Springfield school

We returned to Hymba Yumba this year to photograph the school. The independent community school, for prep students to Year 12, opened to its first intake of students in 2013. The school provides a culturally connected environment for its Indigenous students, drawing on the knowledge of elders and families.



Future plans for schools

A tailored master planning approach responds to a school's culture and supports its learning objectives. This year our master planning focus was on schools in major regional centres — **Chanel College** in Gladstone (completed with Stephen Bowers, Novus Urban) and **Kirwan State High School** in Townsville (completed with Tania Dennis, Insideout Architects, Townsville).



Above: Internal workshop – reviewing 10+ years of schools master planning

Project School master plan / Client Chanel College, Gladstone



New facilities for Kirwan

This three-storey building adds 20 general learning areas for one of Queensland's largest state high schools. The new teaching and support spaces will be fully functional for the start of the 2015 school year.





Inner-city residential

The Plaza, South Brisbane, was completed in late 2014 — 168 apartments over 12 storeys, close to open green space, employment, transport and South Bank's cultural precinct. The Plaza's east facing apartments overlook Musgrave Park and a shared terrace has views north to the city and west to Mt Coot-tha.

Our work on **Central Village** in Fortitude Valley began with contributing to the development's master plan, along with bureau^proberts. The practice has designed the adaptive re-use of the site's heritage-listed drill hall as well as stage 2, Oxford Towers, and a fifth stage tower. The development provides some of the last NRAS (National Rental Affordability Scheme) housing in inner Brisbane.

The practice also designed the **Fleet Lane** apartments, which overlook the city from a laneway location in South Brisbane. Construction of the 66 apartments has begun. Client: RGD Constructions, for HCAP Developments.





Urban integrated care

Plans progressed for a 120-bed high care residential development for **St Vincent's Care Services**. The Maroochydore site is currently home to the Stella Maris Catholic Church and a new church building is central to the redevelopment project. A wellness centre, seniors gym, activity spaces and café are also planned. The intention is to provide integrated care in a high amenity urban centre, strongly connected to the existing community. Creative Residential Communities provided specialist advice to the project.



Project Stella Maris Redevelopment Project (interior) / **Client** St Vincent's Care Services

Project Church concept design, Stella Maris Redevelopment Project / **Client** Stella Maris Catholic Parish, Maroochydore



TRUDI awarded

The 'Great local places' program offers training and capacity building options for local authorities — workshops, seminars, strategies to improve planning and development processes, placemaking and advocacy. The program was piloted in Toowoomba as an urban design initiative (TRUDI), developed by Mike McKeown and Deicke Richards. The Toowoomba initiative was highly commended in the 2014 Innovation Awards, presented during the Australian Regional Development Conference in Albury. The program shows how good urban design principles are the foundation for places that are liveable, thriving and sustainable.

Above: Participants in a *Design, Thinking, Drawing* workshop



A tailored programme

In-house coordination and support

Workshops and seminars

Training, team building

Planning and development

Improving processes

Demonstration projects

Placemaking

Urban design advisory panel

Capacity building

Urban design champion

Advocacy

Awards

Recognising excellence, raising awareness

Project

Toowoomba region urban design initiative (TRUDI)

Client

Toowoomba Regional Council

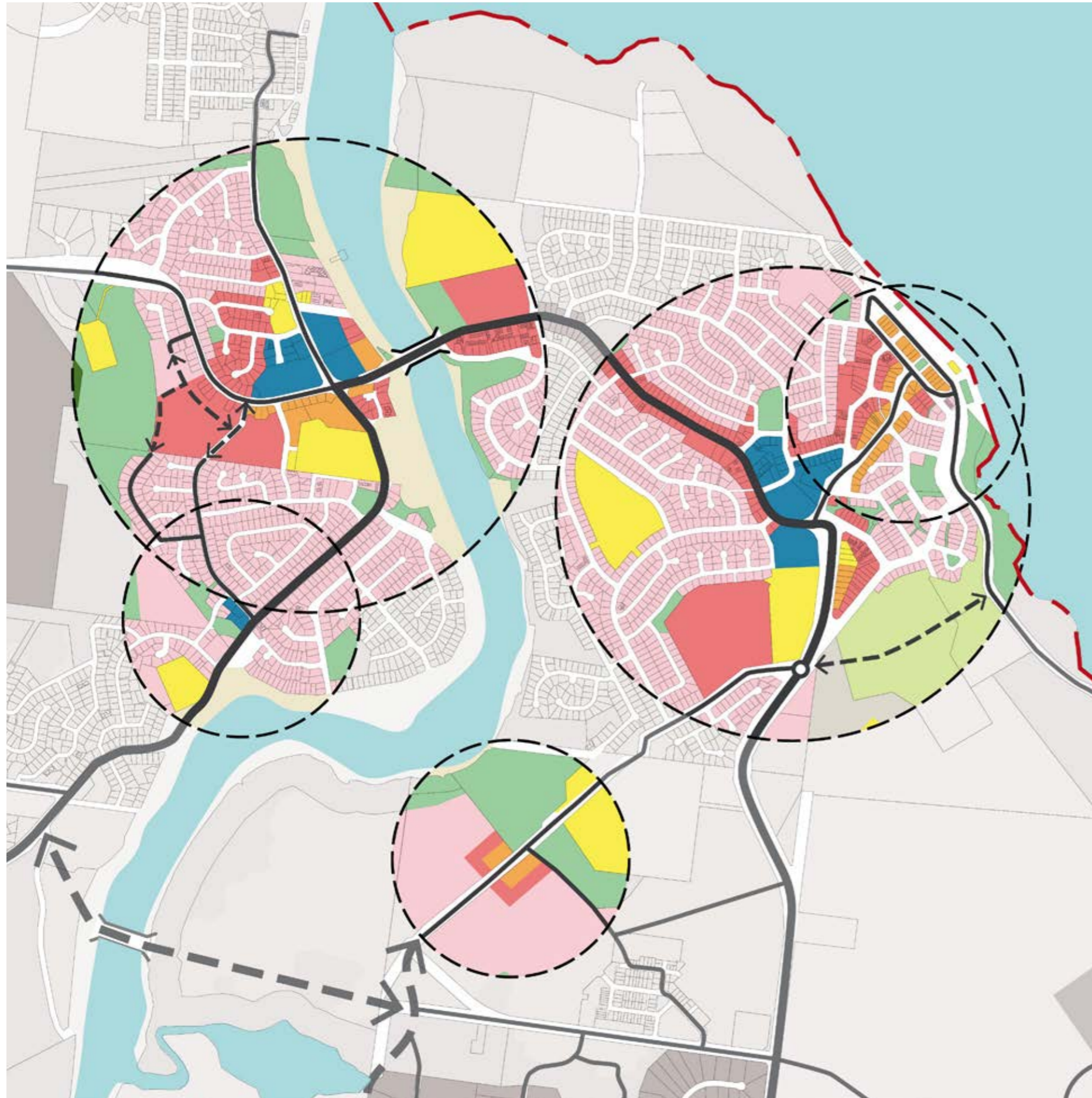

Growth and change in regional centres

The specific challenges of growth and change in regional centres are a key focus for the urban design and planning team. Working with Buckley Vann, we assisted Gladstone Regional Council (GRC) to prepare its new **planning scheme** which incorporated a form-based codes approach. The work was undertaken in parallel with the development of structure plans for **Boyne Island and Tannum Sands, Calliope and Agnes Water / Seventeen Seventy**, and an urban design study for Gladstone. A program of community consultation informed the team's work, which forecasts a more sustainable urban form for the region's future.



Selected additional urban design & planning projects

—Queens Wharf Brisbane

The practice is leading the urban design and public amenity component of the technical advisory services team for Queens Wharf Brisbane. The work is being completed in partnership with Conrad Gargett Riddel Ancher Mortlock Woolley. A preferred proponent is expected to be announced early 2015.

—Yeerongpilly Green

Deicke Richards led the consultant team which prepared the initial concept plan of development for the Yeerongpilly TOD and this year we finalised input to the site's Detailed Plan of Development. The 14ha riverfront Yeerongpilly Green has now moved into the development and delivery phase.

—Redland harbour schemes

Detailed structure plans were prepared this year for **Toondah Harbour** and **Weinam Creek**, bay-side gateways to Stradbroke Island and the Southern Moreton Bay Islands. With inputs from a team of consultants, the plans informed the development schemes released for the two localities.

—Tropical FNQ master plan

We contributed to master planning a proposed \$200m residential development north of Cairns. The master plan for Botanica includes a mix of apartments, villas and row houses, highly responsive to the tropical environment.

—Health City development

Concept designs were produced for a mixed-use development adjacent to the Mater Private Hospital, currently being constructed. Deicke Richards has contributed to master planning for Springfield's 52ha health and wellness precinct, Health City, since 2006.

2014 staff

Eloise Atkinson / Cassie Batten / Lucy Bland / Yasmin Crawford /
Cameron Davies / John Deicke / Anne Dobson / Shem Guthrie /
Ian Hamilton / Meg Hinchliffe / Tom Kaye / Candece Long /
Ingrid Marshall / Caitlin McDonnell / Magda Myszkowski /
Shirley Powell / Peter Richards / Phil Smith / Stephen Smith /
Josh Spillane / Nick Vella / Luke Watson / Tim Zieth

Photography

Cover page, Resources Building, USC
and Hymba Yumba Community Hub /
Christopher Frederick Jones

Kirwan State High School / courtesy Watpac

Aerial and detail, The Plaza, South Brisbane /
courtesy Metro Property Development

3D visualisations

Central Village Stage 2, Fortitude Valley /
courtesy Metro Property Development

Stella Maris Redevelopment Project (interior) /
Response Image

Church concept design, Stella Maris
Redevelopment Project / Off the Cuffe

Architecture
Urban design
Community design

DEICKE RICHARDS

Brisbane
Sunshine Coast
www.deickerichards.com.au